

RETAINING WALL DETAIL

WATERPROOFING TO RETAINING WALL SPECIFICATION & DETAIL

H

Preparation:

- 1.1. Ensure concrete floors are level, smooth, and free of voids, protrusions, and cracks.
- 1.3. Installation shall adhere to AS654.2 2012 Waterproofing membrane systems for internal use.
- 1.4. Cross-reference NCC 2022 Volume Two - Building Code of Australia Class 1 and 10 buildings.

2. Primer:

- 2.1. Apply one coat of ACTFLEX 988 CWP to the previously prepared surfaces of retaining walls, with a 100mm return onto the floor footing.
- 2.2. Dilute the first coat of ACTFLEX 988 CWP with 5% water for total penetration.
- 2.3. Allow 6 hours drying time at 25°C and 50% relative humidity (R.H.) or as per Technical Data Sheet (TDS) instructions.

3. Joint Sealant:

- 3.1. Apply a 15mm x 15mm fillet of ACTFLEX MS PRO joint sealant on all horizontal and vertical joints of the retaining wall.

4. Reinforcing Polyester Mesh (Used along floor/wall junctions):

- 4.1. Apply one coat of ACTFLEX 988 CWP, extending at least 150mm on either side of the corner junction.
- 4.2. Embed the AT-MESH tape into the wet coat of the corner junction.
- 4.3. Smooth out any bubbles or wrinkles, ensuring a secure bond between the tape and substrate, and proper moulding into all corner junctions.
- 4.4. Allow a minimum of 6 hours of setting/drying time at 25°C and 50% R.H. or as per TDS.

5. Waterproofing Membrane:

- 5.1. Apply two coats of ACTFLEX 988 waterproofing membrane to the retaining wall areas, including a minimum 100mm return onto the footing.
- 5.2. The total dry film thickness of ACTFLEX 988 CWP must be a minimum of 1.2mm or 1200 microns.
- 5.3. Allow a minimum of 6 hours of drying time between coats and 72 hours for full cure at 25°C and 50% R.H. or as per TDS.

6. Waterproofing Protection:

- 6.1. After full cure of the waterproofing system, install HIFLOW DRAINAGE CELL on planter box walls and floor area, overlapping each other by 100mm at the joints.

Always consult with a Actech Protective Coatings Representative for regulations specific to your wet areas, as they may have additional requirements for waterproofing projects.

RETAINING WALL DETAIL

LEGEND

- V TECH MS
- ACTFLEX 988 CWP
- AT MESH

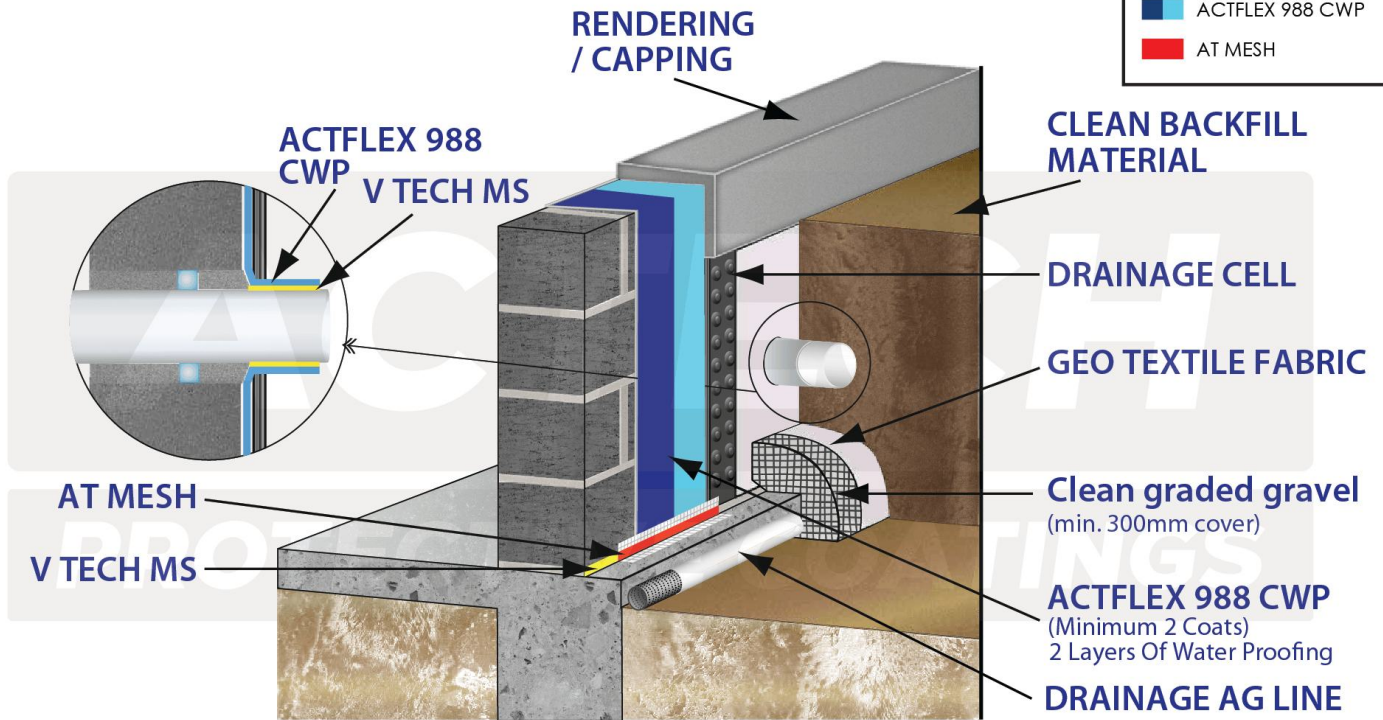

The provided drawings and waterproofing details are intended to serve as general guidelines. It is the responsibility of the user to ensure the correct application of the products as per the specified instructions. These details are not exact to site-specific conditions and must be thoroughly reviewed and clarified prior to installation. It is imperative that all site conditions and any potential variations are considered, and that necessary adjustments are made to suit the specific requirements of the project. Any discrepancies or uncertainties should be addressed and resolved in consultation with our technical support team to ensure proper implementation.

DETAIL NAME
DRAWING NUMBER
SIGNED BY
DATE



CONDITIONS OF USE, PRODUCT DISCLAIMER AND STATEMENT OF RESPONSIBILITY

The information supplied is given in good faith and to the best of our knowledge is true and accurate at the time of printing. As the information herein is of a general nature, no assumption can be made as to a product's suitability for a particular use of application and no warranty as to accuracy, reliability or completeness either expressed or implied is given other than those required by Commonwealth or State Legislation. We reserve the right to update information without prior notice to you to reflect our ongoing research and development program. The customer or the contractor is responsible for checking the suitability of products for their intended use. It is the customers' responsibility to ensure that our products are used and handled correctly and in accordance with any applicable Australian Standards. Our instructions and recommendations are only for intended users only. Any advice, recommendation, information, assistance or service provided by Actech Protective Coatings in relation to its products or their use is given in good faith, however is provided without responsibility or liability. To the full extent permitted by law, Actech Protective Coatings Products liability is limited to its discretion, to replace or to refund the purchase price of the quantity of the products supplied. Actech Protective Coatings does not exclude rights and remedies that cannot be excluded by legislation, for example under the Consumer Guarantees Act 1993. Under no circumstances will the company be liable for loss, consequential or otherwise, arising from the use of the product.



ACTECH PROTECTIVE COATINGS

(02) 8021 3517 admin@actechpc.com.au Unit 22/872 Canterbury Road Roselands NSW 2196
www.thewaterproofingshop.com.au