

# BATHROOM DETAIL

## WATERPROOFING TO BATHROOM AREAS WITH SECONDARY MEMBRANE SPECIFICATION

### BATHROOM WALLS

#### 1. Key Metrics:

- 1.1. Ensure walls are level, smooth, and free of voids, protrusions, and cracks.
- 1.2. Installation shall adhere to AS3740 - 2021 Waterproofing membrane systems for internal use.
- 1.43. Cross-reference NCC 2022 Volume Two - Building Code of Australia Class 1 and 10 buildings.

#### 2. Preparation:

- 2.1. All surfaces to be waterproofed must be firm, clean, dry, sound, and smooth.
- 2.2. Remove all grease, oil, wax, curing compounds, loose material, paint, and other contaminants.
- 2.3. Conduct moisture meter and substrate surface temperature measurements before commencing any waterproofing systems.

#### 3. Primer Application:

- 3.1. Apply 1 coat of ACTFLEX 600 PRIMER to shower walls extending a minimum of 150mm past the shower screen area.
- 3.2. Apply 1 coat of ACTFLEX 600 PRIMER to Vanity walls, Bathtub walls and any other walls that require Water resistance.
- 3.2. Allow 1-3 hours to dry @ 25°C and 50% R.H. for ACTFLEX 600 PRIMER.
- 3.3. Prime all pipe penetrations with ACTFLEX SUPER BOND 007 primer.

#### 4. Joint Sealant:

- 4.1. Apply a 12mm x 12mm fillet of V TECH MS joint sealant on all floor/wall corner junctions and pipe penetrations.
- 4.2. Allow 20-60 minutes drying time to achieve a tack-free finish.

#### 5. Waterproofing Membrane:

- 5.1. Apply a minimum of two coats of ACTFLEX 906 WPU membrane to the previously primed surfaces for shower, vanity and bathtub wall areas,
- 5.2. Achieve a Dry Film Thickness (DFT) of 1.2mm or 1200 microns for shower walls only with a coverage of approximately 10-12m<sup>2</sup> finished dry film thickness.
- 5.3. 5.2. Achieve a Dry Film Thickness (DFT) of 0.6mm or 600 microns for vanity, bathtub and other walls areas with a coverage of approximately 10-12m<sup>2</sup> finished dry film thickness.
- 5.4. Allow 24 hours drying time between coats and 48 hours after the final coat at 25°C and 50% R.H.

Always consult with a Actech Protective Coatings Representative for regulations specific to your wet areas, as they may have additional requirements for waterproofing projects.

## BATHROOM FLOORS

### 1. Key Metrics:

- 1.1. Ensure concrete floors are level, smooth, and free of voids, protrusions, and cracks.
- 1.2. All falls must have a 1:100 degree slope/fall in the substrate.
- 1.3. Installation shall adhere to AS3740 - 2021 Waterproofing membrane systems for internal use.
- 1.4. Cross-reference NCC 2022 Volume Two - Building Code of Australia Class 1 and 10 buildings.

### 2. Preparation:

- 2.1. All surfaces to be waterproofed must be firm, clean, dry, sound, and smooth.
- 2.2. Remove all grease, oil, wax, curing compounds, loose material, paint, and other contaminants.
- 2.3. Conduct moisture meter and substrate surface temperature measurements before commencing any waterproofing systems.

### 3. Drainage Outlets:

- 3.1. Retro fit all drainage outlets to comply with AS3740 - 2021 regulated puddle flanges.
- 3.2. Recess the Puddle Flanges (if not cast-in-situ) into the substrate without protruding above it.

### 4. Primer Application:

- 4.1. Apply 1 coat of ACTFLEX 600 PRIMER to all floor areas, including a minimum of 150mm upturns on balconies and terraces.
- 4.2. Allow 1-3 hours to dry @ 25°C and 50% R.H. for ACTFLEX 600 PRIMER.
- 4.3. Prime all pipe penetrations with ACTFLEX SUPER BOND 007 primer.

### 5. Joint Sealant:

- 5.1. Apply a 12mm x 12mm fillet of VTECH MS joint sealant on all floor/wall corner junctions and pipe penetrations.
- 5.2. Allow 20-60 minutes drying time to achieve a tack-free finish.

### 6. Floor Wastes:

- 6.1. After priming, install ACTNOW 100mm RUBBER PUDDLE FLANGES on all floor wastes using ACTFLEX 75FC joint sealant to secure the wall and lip of the flange to the floor and primed PVC pipe surface.
- 6.2. Ensure secure adhesion of all flange surfaces to the PVC pipe and concrete flooring by applying hand pressure.

### 7. Waterproofing Membrane:

- 7.1. Apply a minimum of two coats of ACTFLEX 906 WPU membrane to the previously primed surfaces for entire roof floor area, including upturns, hobs, parapet walls, and drainage outlets.
- 7.2. Achieve a Dry Film Thickness (DFT) of 1.2mm or 1200 microns with a coverage of approximately 8-10m<sup>2</sup> finished dry film thickness.
- 7.3. Allow 6 hours drying time between coats and 48 hours after the final coat for full cure at 25°C and 50% R.H.

# BATHROOM DETAIL

LEGEND	
<span style="display:inline-block; width:15px; height:10px; background-color:yellow; border:1px solid black;"></span>	ACTFLEX 600 PRIMER
<span style="display:inline-block; width:15px; height:10px; background-color:lightblue; border:1px solid black;"></span>	ACTFLEX 906 WPU
<span style="display:inline-block; width:15px; height:10px; background-color:teal; border:1px solid black;"></span>	ACTFLEX MS PRO
<span style="display:inline-block; width:15px; height:10px; background-color:purple; border:1px solid black;"></span>	ACTFLEX SUPER BOND 007

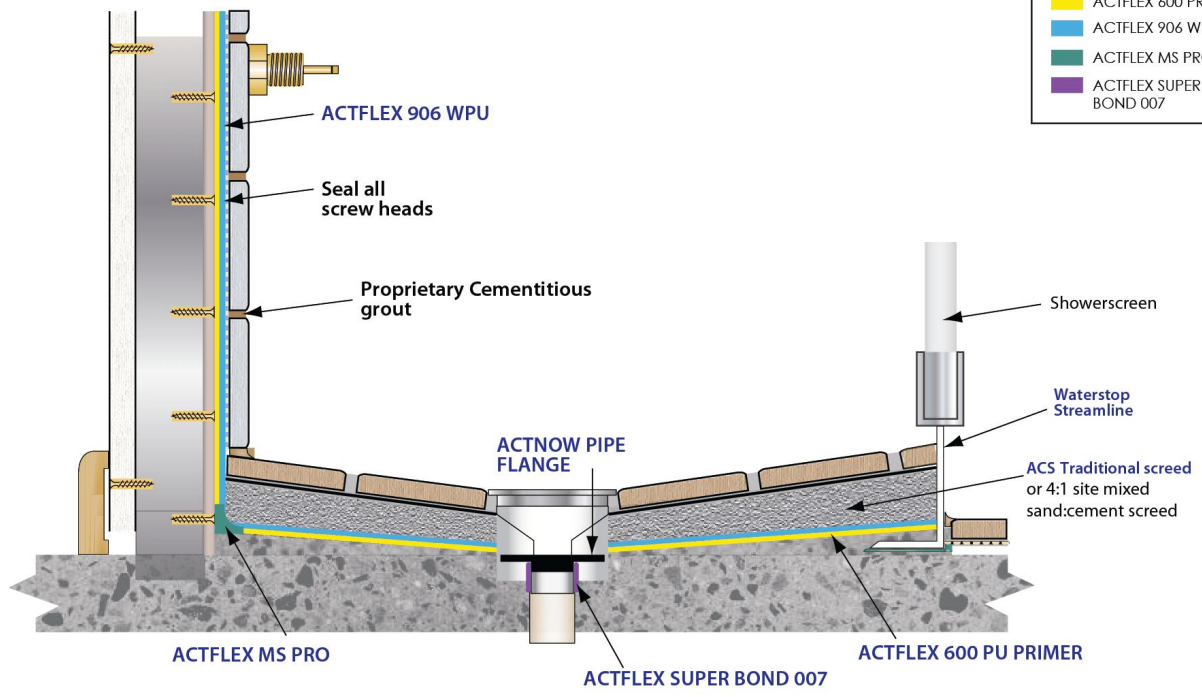

The provided drawings and waterproofing details are intended to serve as general guidelines. It is the responsibility of the user to ensure the correct application of the products as per the specified instructions. These details are not exact to site-specific conditions and must be thoroughly reviewed and clarified prior to installation. It is imperative that all site conditions and any potential variations are considered, and that necessary adjustments are made to suit the specific requirements of the project. Any discrepancies or uncertainties should be addressed and resolved in consultation with our technical support team to ensure proper implementation.

DETAIL NAME
DRAWING NUMBER
SIGNED BY
DATE



## CONDITIONS OF USE, PRODUCT DISCLAIMER AND STATEMENT OF RESPONSIBILITY

The information supplied is given in good faith and to the best of our knowledge is true and accurate at the time of printing. As the information herein is of a general nature, no assumption can be made as to a product's suitability for a particular use of application and no warranty as to accuracy, reliability or completeness either expressed or implied is given other than those required by Commonwealth or State Legislation. We reserve the right to update information without prior notice to you to reflect our ongoing research and development program. The customer or the contractor is responsible for checking the suitability of products for their intended use. It is the customers' responsibility to ensure that our products are used and handled correctly and in accordance with any applicable Australian Standards. Our instructions and recommendations are only for intended users only. Any advice, recommendation, information, assistance or service provided by Actech Protective Coatings in relation to its products or their use is given in good faith, however is provided without responsibility or liability. To the full extent permitted by law, Actech Protective Coatings Products liability is limited to its discretion, to replace or to refund the purchase price of the quantity of the products supplied. Actech Protective Coatings does not exclude rights and remedies that cannot be excluded by legislation, for example under the Consumer Guarantees Act 1993. Under no circumstances will the company be liable for loss, consequential or otherwise, arising from the use of the product.



### ACTECH PROTECTIVE COATINGS

(02) 8021 3517    admin@actechpc.com.au    Unit 22/872 Canterbury Road Roselands NSW 2196  
[www.thewaterproofingshop.com.au](http://www.thewaterproofingshop.com.au)